





## VALVOLE A SFERA

- Di solida e robusta costruzione.
- Parti a contatto con il fluido costruite esclusivamente in acciaio inossidabile AISI 316L. A richiesta, disponibili in acciaio inossidabile AISI 304L.
- Facilmente sterilizzabili. Elementi interni facilmente raggiungibili durante le fasi di lavaggio CIP nei modelli 50 e 51.
- Facilmente disassemblabili. Disassemblaggio in linea nei modelli 90 e 91. Guarnizione sanitaria nel modello 90.
- Sfera contenuta all'interno delle flange e conseguente alleggerimento della struttura e riduzioni dell'ingombro valvola nel modello 81; un'estremità a saldare e un'estremità a richiesta a norme DIN, SMS, RJT, ISS, Gas, Eno, Macon.
- Corredabili di comandi manuali o pneumatici.
- Comandi pneumatici orizzontali e verticali a semplice effetto, doppio effetto e di regolazione flusso, corredabili di contatto di prossimità, microinterruttore (elettrico o pneumatico), elettrovalvola (24V CA, 24 V CC, 48 V CA), connettore.
- Massima pressione di esercizio: 10 bar.
- Possibilità di intercambiabilità tra le varie unificazioni.
- Finitura standard: lucidatura esterna e satinatura interna grana 150. Altre finiture a richiesta.

## BALL VALVES

- Heavy duty construction.
- Parts in contact with the fluid made exclusively of AISI 316L stainless steel. On request available in AISI 304L stainless steel.
- Easy to sterilize. Internal parts easy to reach during CIP process in models 50 and 51.
- Easy to disassemble. On-line disassembly in models 90 and 91. Sanitary gasket in model 90.
- Ball contained in the flange with resulting lightening of the structure and reduction of valve volume in the 81 model. One welded end and one end, on request, produced in conformity with DIN, SMS, RJT, ISS, BSP, Eno and Macon standards.
- Can be equipped with manual or pneumatic controls.
- Horizontal and vertical single-, double-effect, and modulating pneumatic controls. Can be equipped with proximity contact, microswitch (electrical or pneumatic), solenoid valve (24 V AC, 24 V DC, 48 V AC), connector.
- Maximum operating pressure: 10 bars.
- Interchangeability between the different standards available.
- Standard finish: 150 grain external polishing and internal glazing. Other finishes on request.

## VANNES À BOULE

- Fabrication solide et robuste.
- Parties en contact avec le fluide fabriquées exclusivement en acier inoxydable AISI 316L. Sur demande, disponibles en acier inoxydable AISI 304L.
- Facilement stérilisables. Éléments internes faciles à atteindre durant les opérations de lavage CIP pour les modèles 50 et 51.
- Facilement démontables. Démontage en ligne pour les modèles 90 et 91. Joint sanitaire pour le modèle 90.
- La boule contenue à l'intérieur des brides allège la structure et réduit l'encombrement de la vanne modèle 81; un bout à souder et un bout, sur demande, conforme aux normes DIN, SMS, RJT, ISS, Gas, Eno, Macon.
- Peuvent être munies de commandes manuelles ou pneumatiques.
- Commandes pneumatiques horizontales et verticales à simple effet, double effet et pour le réglage du flux; peuvent être munies de contact de proximité, minirupteur (électrique ou pneumatique), électrovanne (24 V CA, 24 V CC, 48 V CA), connecteur.
- Pression d'exploitation maximum: 10 bars.
- Intercambiabilité possible entre les différentes standards.
- Finissage standard: polissage extérieur et satinage intérieur grain 150. Autres finissages sur demande.



## VÁLVULAS DE BOLA

- De fabricación sólida y robusta.
- Las partes que están en contacto con el fluido se fabrican exclusivamente en acero inoxidable AISI 316L. A pedido, se pueden suministrar en acero inoxidable AISI 304L.
- Fácilmente esterilizables. Los elementos internos son fácilmente accesibles durante las fases de lavado CIP en los modelos 50 y 51.
- Se pueden desmontar fácilmente. Desmontaje en línea en los modelos 90 y 91. Junta sanitaria en el modelo 90.
- Bola alojada en el interior de las bridas con consiguiente aligeramiento de la estructura y reducción de las dimensiones de la válvula en el modelo 81; un extremo para soldar y un extremo a pedido según normas DIN, SMS, RJT, ISS, Gas, Eno, Macon.
- Equipadas con mandos manuales o neumáticos.
- Mandos neumáticos horizontales y verticales de simple efecto, doble efecto y de regulación del flujo que se pueden equipar con microsensor, microrruptor (eléctrico o neumático), electroválvula (24 V CA, 24 V CC, 48 V CA), conector.
- Máxima presión de ejercicio: 10 bares.
- Posibilidad de intercambio entre las distintas unificaciones.
- Acabado estándar: pulido exterior y satinado interior grano 150. A pedido, se pueden suministrar otros acabados.



**VALVOLA A SFERA CON DRENAGGIO**  
**DRAINAGE BALL VALVE**  
**VANNE À BOULE AVEC DRAINAGE**  
**VÁLVULA DE BOLA CON DRENAJE**

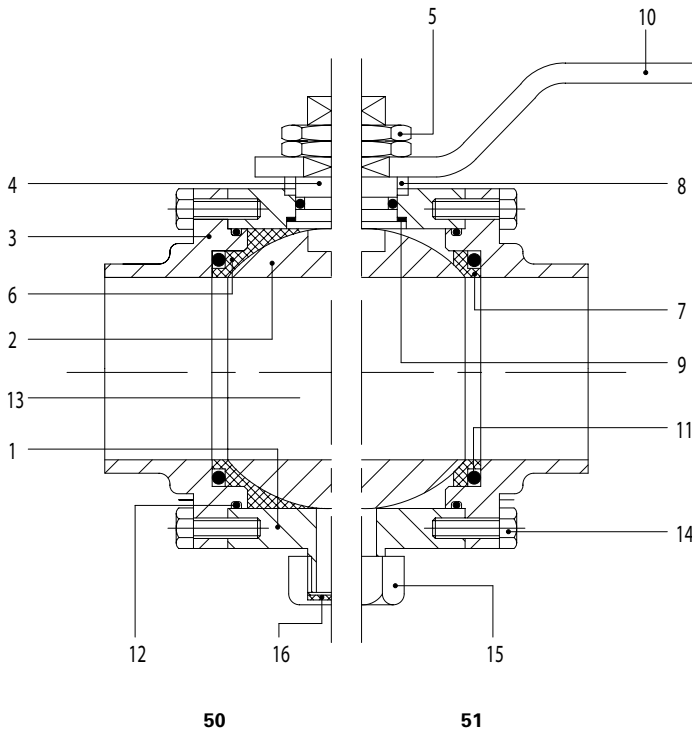

- |   |   |
|---|---|
| 1. Corpo valvola<br>Valve body<br>Corps vanne<br>Cuerpo                           | 9. Rondella<br>Washer<br>Rondelle<br>Arandela                                 |
| 2. Sfera<br>Ball<br>Boule<br>Bola   | 10. Maniglia<br>Handle<br>Poignée<br>Maneta                                   |
| 3. Flangia<br>Flange<br>Bride<br>Brida  | 11. Anello di tenuta OR<br>OR seal ring<br>Joint torique<br>Junta OR          |
| 4. Perno<br>Spindle<br>Pivot<br>Perno   | 12. Anello di tenuta OR<br>OR seal ring<br>Joint torique<br>Junta OR          |
| 5. Dado esagonale<br>Hexagonal nut<br>Écrou hexagonal<br>Tuerca hexagonal         | 13. Anello di tenuta OR<br>OR seal ring<br>Joint torique<br>Junta OR          |
| 6. Guarnizione sanitaria<br>Sanitary gasket<br>Joint sanitaire<br>Junta sanitaria | 14. Vite esagonale<br>Hexagonal screw<br>Vis hexagonale<br>Tornillo hexagonal |
| 7. Guarnizione<br>Gasket<br>Joint<br>Junta  | 15. Dado esagonale<br>Hexagonal nut<br>Écrou hexagonal<br>Tuerca hexagonal    |
| 8. Distanziale<br>Spacer<br>Entretoise<br>Distanciador                            | 16. Pastiglia PTFE<br>PTFE pin<br>Pastille PTFE<br>Pastilla PTFE              |

CODIFICAIONE  
CODING  
CODIFICATION  
CODIFICACIÓN

Pos.	Cod. base	Norme	1"	1 1/2"	2"	2 1/2"	3"	4"	Mat.	Part. o agg.
1	K51		25	38	51	63	76	101	6L	01
2	K51		25	38	51	63	76	101	6L	02
3	K51	K	1"	1 1/2"	2"	2 1/2"	3"	4"	6L	03
3	K51	W	25	38	51	63	76	101	6L	03
4	K51		25	38/101	38/101	38/101	38/101	38/101	4L	04
5	K51		25	38/101	38/101	38/101	38/101	38/101	4L	05
6	K51		25	38	51	63	76	101	T	06
7	K51		25	38	51	63	76	101	T	07
8	K51		25	38/101	38/101	38/101	38/101	38/101	4L	08
9	K51		25	38/101	38/101	38/101	38/101	38/101	T	09
10	K51		25	38/101	38/101	38/101	38/101	38/101	4L	10
11	OR		3106	4162	158	6275	6312	6450	N	
12	OR		3125	3200	3262	3325	3400	3550	N	
13	OR		3043	3050	3050	3050	3050	3050	N	
14	VE		6x12	6x16	6x16	6x16	6x16	6x16	4L	
15	K51		25/101	25/101	25/101	25/101	25/101	25/101	4L	15
16	K51		25/101	25/101	25/101	25/101	25/101	25/101	T	16



VALVOLA A SFERA  
BALL VALVE  
VANNE À BOULE  
VÁLVULA DE BOLA

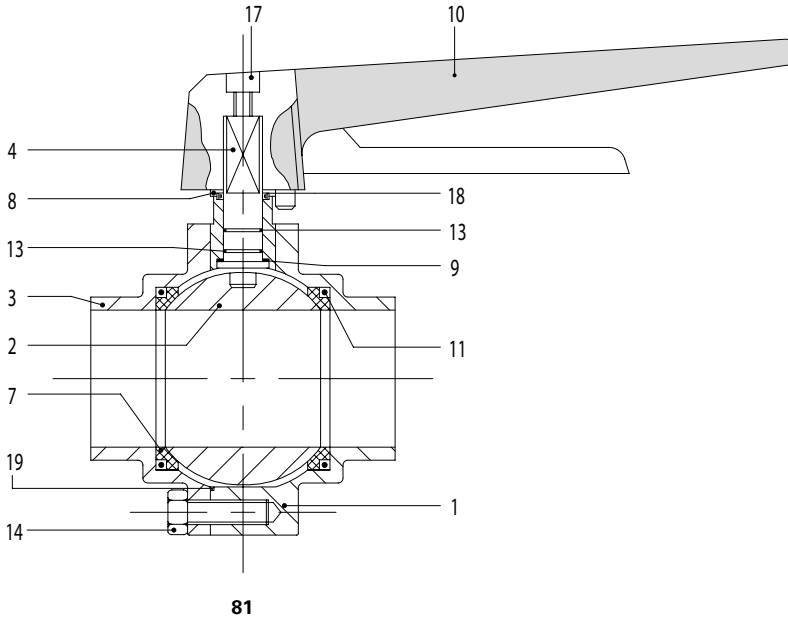

81

- |   |   |
|---|---|
| 1. Corpo valvola<br>Valve body<br>Corps vanne<br>Cuerpo | 10. Maniglia<br>Handle<br>Poignée<br>Maneta                               |
| 2. Sfera<br>Ball<br>Boule<br>Bola                       | 11. Anello di tenuta OR<br>OR seal ring<br>Joint torique<br>Junta OR      |
| 3. Flangia<br>Flange<br>Bride<br>Brida                  | 13. Anello di tenuta OR<br>OR seal ring<br>Joint torique<br>Junta OR      |
| 4. Perno<br>Spindle<br>Pivot<br>Perno                   | 14. Vite esagonale<br>Hexagonal screw<br>Vis 6 pans<br>Tornillo hexagonal |
| 7. Guarnizione<br>Gasket<br>Joint<br>Junta              | 17. Vite brugola<br>Allen screw<br>Vis Allen<br>Tornillo Allen            |
| 8. Distanziale<br>Spacer<br>Entretoise<br>Distanciador  | 18. Rondella PTFE<br>PTFE washer<br>Rondelle PTFE<br>Arandela PTFE        |
| 9. Rondella<br>Washer<br>Rondelle<br>Arandela           | 19. Anello PTFE<br>PTFE ring<br>Joint PTFE<br>Junta PTFE                  |

CODIFICAZIONE  
CODING  
CODIFICATION  
CODIFICACIÓN

Pos.	Cod. base	Norme	1 1/2" 38	D 40 40	2" 51	D 50 52	2 1/2" 63	D 65 70	3" 76	D 80 85	Mat.	Part. o agg.
1	81		38/40	38/40	51/52	51/52	63	70	76	85	6L	01
2	71		38/40	38/40	51/52	51/52	63	70	76	85	6L	02
3	71	W	38	40	51	52	63	70	76	85	6L	03
3	71	D		40		50		65		80	6L	03
3	71	S	38		51		63		76		6L	03
3	71	B	38		51		63		76		6L	03
3	71	I	38		51		63		76		6L	03
4	71		38/40	38/40	51/52	51/52	63	70	76	85	4L	04
7	71		38/40	38/40	51/52	51/52	63	70	76	85	T	07
8	71		38/52	38/52	38/52	38/52	63/85	63/85	63/85	63/85	4L	08
9	71		38/52	38/52	38/52	38/52	63/85	63/85	63/85	63/85	T	09
10	7M8		25/76	25/76	25/76	25/76	25/76	25/76	25/76	85/101	A	
11	OR		3181	3181	3218	3218	4275	177	4325	4337	N	
13	OR		108	108	108	108	2043	2043	2043	2043	N	
14	VE		6x16	6x16	6x16	6x16	6x16	6x16	6x16	6x16	4L	
17	TCCE		6x16	6x16	6x16	6x16	6x16	6x16	6x16	6x16	4L	
18	91		38/52	38/52	38/52	38/52	63/85	63/85	63/85	63/85	T	18
19	71		38/40	38/40	51/52	51/52	63	70	76	85	T	19





VALVOLE A SFERA ESTRAIBILE  
EXTRACTABLE BALL VALVE  
VANNE À BOULE EXTRAIBILE  
VÁLVULA DE BOLA ESTRAÍBLE

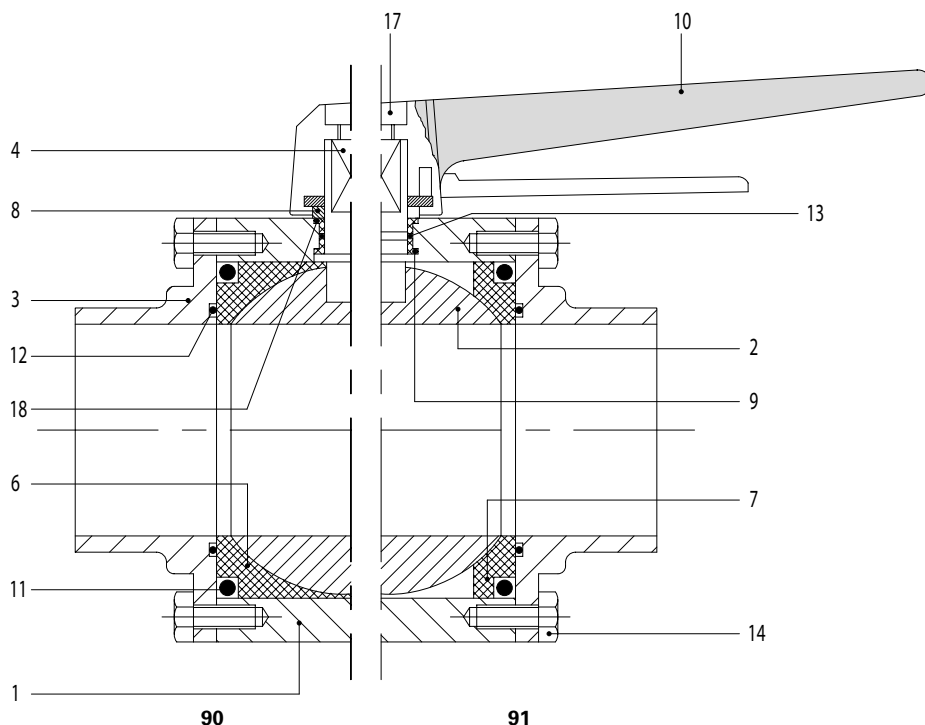

- |   |  |
|---|--|
| 1. Corpo valvola<br>Valve body<br>Corps vanne<br>Cuerpo                           | 10. Maniglia<br>Handle<br>Poignée<br>Maneta  |
| 2. Sfera<br>Ball<br>Boule<br>Bola   | 11. Anello di tenuta OR<br>OR seal ring<br>Joint torique<br>Junta OR               |
| 3. Flangia<br>Flange<br>Bride<br>Brida  | 12. Anello di tenuta OR<br>OR seal ring<br>Joint torique<br>Junta OR               |
| 4. Perno<br>Spindle<br>Pivot<br>Perno   | 13. Anello di tenuta OR<br>OR seal ring<br>Joint torique<br>Junta OR               |
| 6. Guarnizione sanitaria<br>Sanitary gasket<br>Joint sanitaire<br>Junta sanitaria | 14. Vite esagonale<br>Hexagonal screw<br>Vis 6 pans<br>Tornillo hexagonal          |
| 7. Guarnizione<br>Gasket<br>Joint<br>Junta  | 17. Vite brugola<br>Allen screw<br>Vis Allen<br>Tornillo Allen                     |
| 8. Distanziale<br>Spacer<br>Entretoise<br>Distanciador                            | 18. Rondella superiore<br>Upper washer<br>Rondelle supérieure<br>Arandela superior |
| 9. Rondella inferiore<br>Lower washer<br>Rondelle inférieure<br>Arandela inferior |  |

CODIFICAZIONE  
CODING  
CODIFICATION  
CODIFICACIÓN

Pos.	Cod. base	Norme	1" 25	D 25 28	D 32 34	1 1/2" 38	D 40 40	2" 51	D 50 52	2 1/2" 63	D 65 70	3" 76	D 80 85	Mat.	Part. o agg.
1	91		25/28	25/28	34/40	34/40	34/40	51/52	51/52	63/70	63/70	76/85	76/85	6L	01
2	91		25/28	25/28	34/40	34/40	34/40	51/52	51/52	63/70	63/70	76/85	76/85	6L	02
3	91	W	25	28	34	38	40	51	52	63	70	76	85	6L	03
3	91	D		25	32		40		50		65		80	6L	03
3	91	S	25			38		51		63		76		6L	03
3	91	B	25			38		51		63		76		6L	03
3	91	I	25			38		51		63		76		6L	03
4	91		25/28	25/28	34/40	34/40	34/40	51/52	51/52	63/70	63/70	76/85	76/85	4L	04
6	90		25/28	25/28	34/40	34/40	34/40	51/52	51/52	63/70	63/70	76/85	76/85	T	06
7	91		25/28	25/28	34/40	34/40	34/40	51/52	51/52	63/70	63/70	76/85	76/85	T	07
8	91		25/52	25/52	25/52	25/52	25/52	25/52	25/52	63/85	63/85	63/85	63/85	4L	08
9	91		25/40	25/40	25/40	25/40	25/40	51/85	51/85	51/85	51/85	51/85	51/85	T	09
10	7M8		25/52	25/52	25/52	25/52	25/52	25/52	25/52	63/85	63/85	63/85	63/85	A	
11	OR		4131	4131	6200	6200	6200	6250	6250	6337	6337	189	189	N	
12	OR		2106	2106	3162	3162	3162	3206	3206	3256	3256	3300	3300	N	
13	OR		2043	2043	2043	2043	2043	2050	2050	2050	2050	2050	2050	N	
14	VE		6X12	6X12	6X16	6X16	6X16	6X16	6X16	6X16	6X16	6X16	6X16	4L	
17	TCCE		6X16	6X16	6X16	6X16	6X16	6X16	6X16	6X16	6X16	6X16	6X16	4L	
18	91		25/40	25/40	25/40	25/40	25/40	51/85	51/85	51/85	51/85	51/85	51/85	T	18



CILINDRO PNEUM. DE.  
PNEUM. ACTUATOR DE.  
VÉRIN PNEUM. DE.  
CILINDRO NEUM. DE.

7C1 L

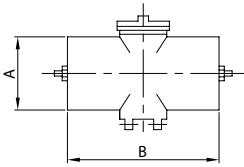

DN	A	B	gr
25/52	60,0	138,5	1.460
63/85	76,0	161,0	2.100
101/104	89,0	180,0	2.960

CILINDRO PNEUM. SE.  
PNEUM. ACTUATOR SE.  
VÉRIN PNEUM. SE.  
CILINDRO NEUM. SE.

7C2 L

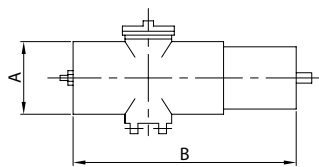

DN	A	B	gr
25/52	76,0	240,0	2.190
63/85	89,0	260,0	3.150

C. PNEUM. REGOL. FLUSSO  
REGUL. FLUX PNEUM. ACT.  
VÉ. PNEUM. RÉGULATION  
CIL. NEUM. REGULACIÓN

7C1 L M

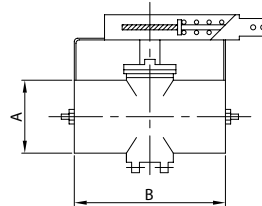

DN	A	B	gr
25/104	89,0	180,0	4.160

C. PNEUM. SE. VERTICALE  
PNEUM. ACT. SE. VERTICAL  
VÉ. PNEUM. SE. VERTICALE  
CIL. NEUM. SE. VERTICAL

7C4 L

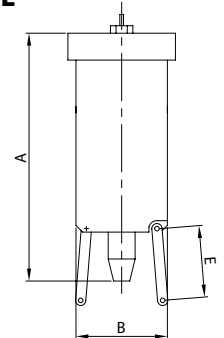

DN	A	B	E	gr
25/52	211,0	76,0	64,0	3.700
63/104	211,0	76,0	58,0	3.700

C. PN. UNITÀ CONTR.  
CONTR. UNIT PN. ACT.  
VÉ. PN. UNITÉ CONTR.  
CIL. N. UNIDAD CONTR.

7C4 UC

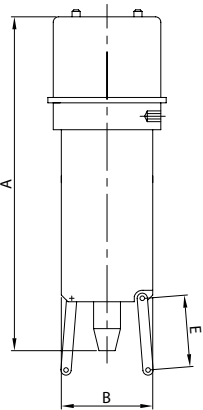

DN	A	B	E	gr
25/52	316,0	76,0	64,0	3.900
63/104	316,0	76,0	58,0	3.900

C. PN. DE. VERTICALE  
PN. ACT. DE. VERTICAL  
VÉ. PN. DE. VERTICALE  
CIL. N. DE. VERTICAL

7C5 L

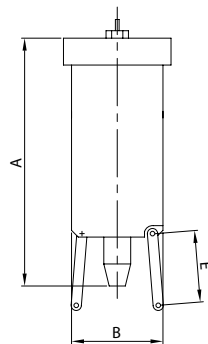

DN	A	B	E	gr
25/52	211,0	76,0	64,0	3.700
63/104	211,0	76,0	58,0	3.700

STAFFA  
BRACKET  
SUPPORT  
BRIDA

7C9 91

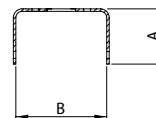

DN	A	B	gr
25	59,0	46,0	200
38	62,0	62,0	210
51	66,5	74,0	240
63	68,5	88,0	260
76	66,0	99,0	260

STAFFA  
BRACKET  
SUPPORT  
BRIDA

7C9 51

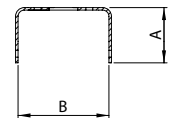

DN	A	B	gr
25	68,5	45,0	220
38	80,5	61,0	240
51	77,0	72,0	260
63	75,5	86,0	300
76	76,0	97,0	300
101	75,5	126,0	330

ELETTROVALVOLA  
SOLENOID VALVE  
ÉLECTROVANNE  
ELECTROVÁLVULA

015 NC

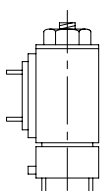

015 NA

MICROINTERRUTTORE  
MICROSWITCH  
MINIRUPTEUR  
MICRORRUPTOR

014 1

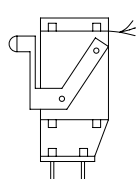

CONTATTO DI PROSSIMITÀ  
PROXIMITY CONTACT  
CONTACT DE PROXIMITÉ  
MICROSENSOR

013 O

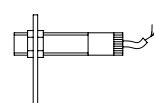

013 S

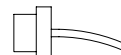

CONNETTORE  
CONNECTOR  
CONNECTEUR  
CONECTOR

030 H

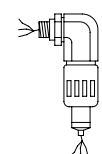

030 S

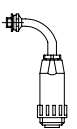



VALVOLA SFERA EL.  
BALL VALVE PE.  
VANNE BOULE BL.  
VÁLVULA BOLA EL.

W81

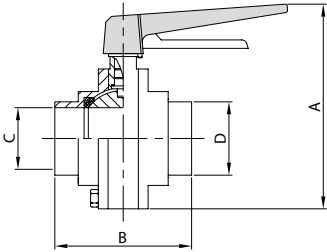

DN	A	B	C	D	gr
40	138,0	73,0	37,0	40,0	1.600
52	155,0	80,0	49,0	52,0	2.600
70	187,0	112,0	66,0	70,0	4.700
85	204,0	121,0	81,0	85,0	5.500

VALVOLA SFERA EF.  
BALL VALVE ME.  
VANNE BOULE BF.  
VÁLVULA BOLA ER.

D81

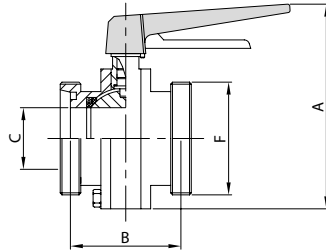

DN	A	B	C	F	gr
40	138,0	73,0	37,0	65-6	1.900
50	155,0	76,0	49,0	78-6	2.900
65	187,0	106,0	66,0	96-6	5.300
80	204,0	114,0	81,0	110-4	6.300

VALVOLA SFERA EL./EF.  
BALL VALVE PE./ME.  
VANNE BOULE BL./BF.  
VÁLVULA BOLA EL./ER.

WD81

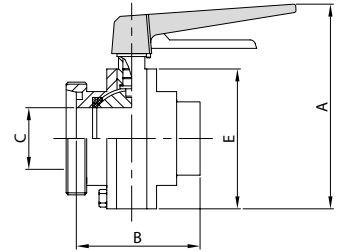

DN	A	B	C	E	gr
40	138,0	73,0	37,0	81,0	1.750
50	155,0	78,0	49,0	98,0	2.750
65	187,0	109,0	66,0	130,0	5.000
80	204,0	117,5	81,0	147,0	5.800

V. SFERA ESTRAIBILE SANIT. EL.  
SANIT. EXTRACTABLE BALL V. PE.  
V. BOULE EXTRACT. SANIT. BL.  
V. BOLA EXTRAIBILE SANIT. EL.

W90

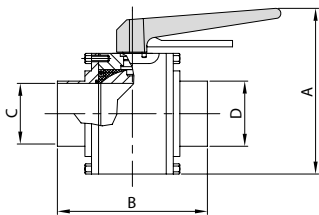

DN	A	B	C	D	gr
28	110,0	95,0	25,0	28,0	1.130
34	130,0	109,0	31,0	34,0	2.070
40	130,0	109,0	37,0	40,0	2.070
52	145,0	124,0	49,0	52,0	2.800
70	168,0	135,0	66,0	70,0	4.840
85	182,0	158,0	81,0	85,0	7.480

V. SFERA ESTRAIBILE SANIT. EF.  
SANIT. EXTRACTABLE BALL V. ME.  
V. BOULE EXTRACT. SANIT. BF.  
V. BOLA EXTRAIBILE SANIT. ER.

D90

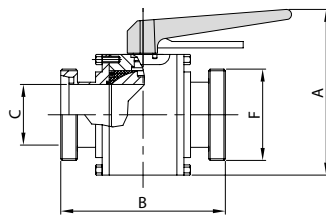

DN	A	B	C	F	gr
25	110,0	110,0	25,0	52-6	1.330
32	130,0	121,0	31,0	58-6	2.370
40	130,0	121,0	37,0	65-6	2.370
50	145,0	132,0	49,0	78-6	3.100
65	168,0	150,0	66,0	95-6	5.440
80	182,0	167,0	81,0	110-4	8.080

V. SFERA ESTR. SANIT. EL./EF.  
SANIT. EXTRACT. BALL V. PE./ME.  
V. BOULE EXTR. SANIT. BL./BF.  
V. BOLA EXTR. SANIT. EL./ER.

WD90

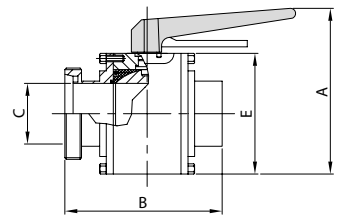

DN	A	B	C	E	gr
25	110,0	102,0	25,0	60,0	1.230
32	130,0	115,0	31,0	80,0	2.220
40	130,0	115,0	37,0	80,0	2.220
50	145,0	128,0	49,0	95,0	2.950
65	168,0	142,0	66,0	118,0	5.140
80	182,0	162,0	81,0	132,0	7.780





V. SFERA ESTRAIBILE EL.  
EXTRACTABLE BALL V. PE.  
V. BOULE EXTRACTION BL.  
V. BOLA EXTRAIBILE EL.

W91

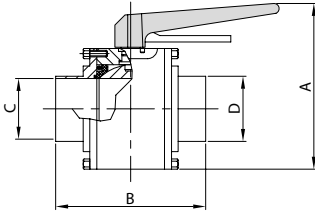

DN	A	B	C	D	gr
28	110,0	95,0	25,0	28,0	1.120
34	130,0	109,0	31,0	34,0	2.060
40	130,0	109,0	37,0	40,0	2.060
52	145,0	124,0	49,0	52,0	2.780
70	168,0	135,0	66,0	70,0	4.820
85	182,0	158,0	81,0	85,0	7.450

V. SFERA ESTRAIBILE EF.  
EXTRACTABLE BALL V. ME.  
V. BOULE EXTRACTION BF.  
V. BOLA EXTRAIBILE ER.

D91

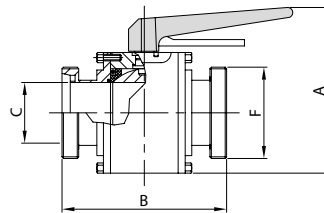

DN	A	B	C	F	gr
25	110,0	110,0	25,0	52-6	1.320
32	130,0	121,0	31,0	58-6	2.360
40	130,0	121,0	37,0	65-6	2.360
50	145,0	132,0	49,0	78-6	3.080
65	168,0	150,0	66,0	95-6	5.420
80	182,0	167,0	81,0	110-4	8.050

V. SFERA ESTRAIBILE EL./EF.  
EXTRACTABLE BALL V. PE./ME.  
V. BOULE EXTRACTION BL./BF.  
V. BOLA EXTRAIBILE EL./ER.

WD91

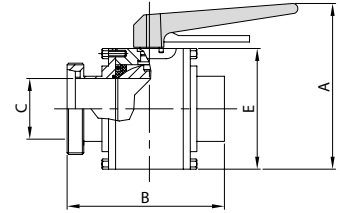

DN	A	B	C	E	gr
25	110,0	102,0	25,0	60,0	1.220
32	130,0	115,0	31,0	80,0	2.210
40	130,0	115,0	37,0	80,0	2.210
50	145,0	128,0	49,0	95,0	2.930
65	168,0	142,0	66,0	118,0	5.120
80	182,0	162,0	81,0	132,0	7.750



VALVOLA SFERA EL.  
BALL VALVE PE.  
VANNE BOULE BL.  
VÁLVULA BOLA EL.

W81

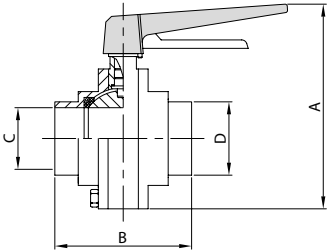

DN	A	B	C	D	gr
38	138,0	73,0	35,1	38,1	1.600
51	155,0	80,0	47,8	50,8	2.600
63	176,0	97,0	60,5	63,5	4.000
76	190,0	109,0	72,9	76,2	5.000

VALVOLA SFERA EF.  
BALL VALVE ME.  
VANNE BOULE BF.  
VÁLVULA BOLA ER.

S81

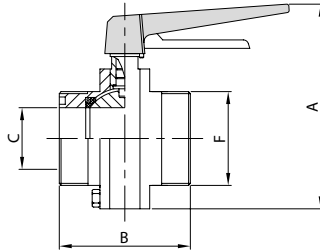

DN	A	B	C	F	gr
38	138,0	87,0	35,1	60-6	1.900
51	155,0	90,0	47,8	70-6	2.900
63	176,0	105,0	60,5	85-6	4.600
76	190,0	121,0	72,9	98-6	5.600

VALVOLA SFERA EL./EF.  
BALL VALVE PE./ME.  
VANNE BOULE BL./BF.  
VÁLVULA BOLA EL./ER.

WS81

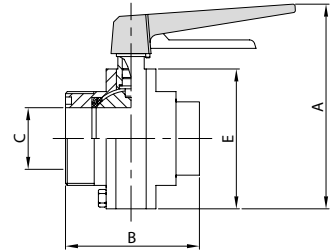

DN	A	B	C	E	gr
38	138,0	80,0	35,1	81,0	1.750
51	155,0	85,0	47,8	98,0	2.750
63	176,0	101,0	60,5	119,0	4.300
76	190,0	115,0	72,9	133,0	5.300

V. SFERA ESTRAIBILE SANIT. EL.  
SANIT. EXTRACTABLE BALL V. PE.  
V. BOULE EXTRACT. SANIT. BL.  
V. BOLA EXTRAIBILE SANIT. EL.

W90

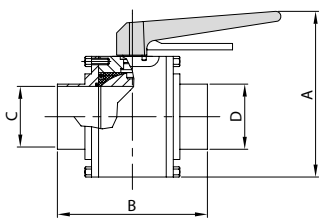

DN	A	B	C	D	gr
25	110,0	95,0	22,1	25,4	1.130
38	130,0	109,0	34,8	38,1	2.070
51	145,0	124,0	47,5	50,8	2.800
63	168,0	135,0	60,2	63,5	4.840
76	182,0	158,0	72,0	76,2	7.480

V. SFERA ESTRAIBILE SANIT. EF.  
SANIT. EXTRACTABLE BALL V. ME.  
V. BOULE EXTRACT. SANIT. BF.  
V. BOLA EXTRAIBILE SANIT. ER.

S90

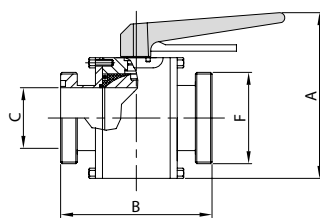

DN	A	B	C	F	gr
25	110,0	95,0	22,1	40-6	1.330
38	130,0	121,0	34,8	60-6	2.370
51	145,0	132,0	47,5	70-6	3.100
63	168,0	146,0	60,2	85-6	5.440
76	182,0	157,0	72,0	98-6	8.080

V. SFERA ESTR. SANIT. EL./EF.  
SANIT. EXTRACT. BALL V. PE./ME.  
V. BOULE EXTR. SANIT. BL./BF.  
V. BOLA EXTR. SANIT. EL./ER.

WS90

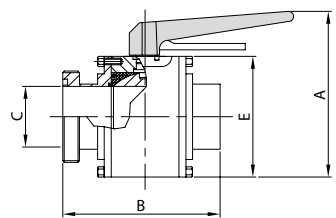

DN	A	B	C	E	gr
25	110,0	95,0	22,1	60,0	1.230
38	130,0	115,0	34,8	80,0	2.220
51	145,0	128,0	47,5	95,0	2.950
63	168,0	140,0	60,2	118,0	5.140
76	182,0	157,0	72,0	132,0	7.780



V. SFERA ESTRAIBILE EL.  
EXTRACTABLE BALL V. PE.  
V. BOULE EXTRACTION BL.  
V. BOLA EXTRAIBILE EL.

**W91**

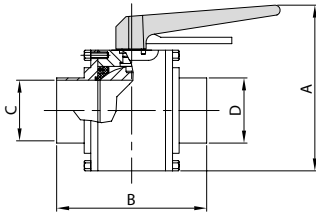

DN	A	B	C	D	gr
25	110,0	95,0	22,1	25,4	1.120
38	130,0	109,0	34,8	38,1	2.060
51	145,0	124,0	47,5	50,8	2.780
63	168,0	135,0	60,2	63,5	4.820
76	182,0	158,0	72,0	76,2	7.450

V. SFERA ESTRAIBILE EF.  
EXTRACTABLE BALL V. ME.  
V. BOULE EXTRACTION BF.  
V. BOLA EXTRAIBILE ER.

**S91**

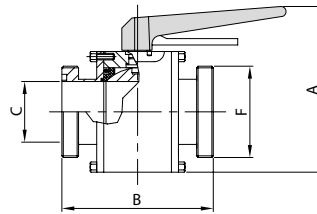

DN	A	B	C	F	gr
25	110,0	95,0	22,1	40-6	1.320
38	130,0	121,0	34,8	60-6	2.360
51	145,0	132,0	47,5	70-6	3.080
63	168,0	146,0	60,2	85-6	5.420
76	182,0	157,0	72,0	98-6	8.050

V. SFERA ESTRAIBILE EL./EF.  
EXTRACTABLE BALL V. PE./ME.  
V. BOULE EXTRACTION BL./BF.  
V. BOLA EXTRAIBILE EL./ER.

**WS91**

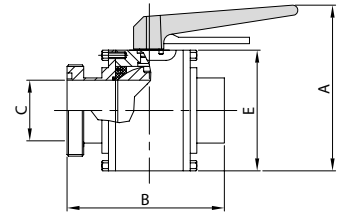

DN	A	B	C	E	gr
25	110,0	95,0	22,1	60,0	1.220
38	130,0	115,0	34,8	80,0	2.210
51	145,0	128,0	47,5	95,0	2.930
63	168,0	140,0	60,2	118,0	5.120
76	182,0	157,0	72,0	132,0	7.750



VALVOLA SFERA EL.  
BALL VALVE PE.  
VANNE BOULE BL.  
VÁLVULA BOLA EL.

**W81**

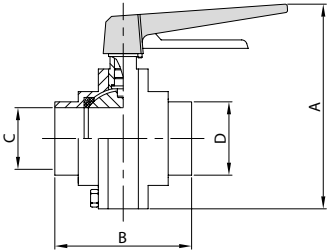

DN	A	B	C	D	gr
38	138,0	73,0	35,1	38,1	1.600
51	155,0	80,0	47,8	50,8	2.600
63	176,0	97,0	60,5	63,5	4.000
76	190,0	109,0	72,9	76,2	5.000

VALVOLA SFERA EF.  
BALL VALVE ME.  
VANNE BOULE BF.  
VÁLVULA BOLA ER.

**B81**

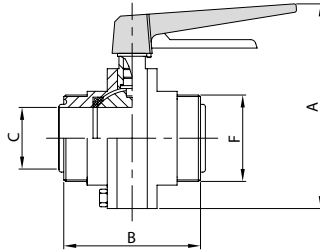

DN	A	B	C	F	gr
38	138,0	88,0	34,8	58-8	1.900
51	155,0	94,0	47,5	73-6	2.900
63	176,0	102,0	60,2	85-6	4.600
76	190,0	116,0	72,9	98-6	5.600

VALVOLA SFERA EL./EF.  
BALL VALVE PE./ME.  
VANNE BOULE BL./BF.  
VÁLVULA BOLA EL./ER.

**WB81**

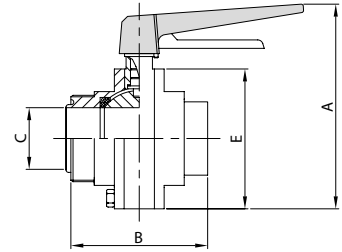

DN	A	B	C	E	gr
38	138,0	80,5	34,8	81,0	1.750
51	155,0	87,0	47,5	98,0	2.750
63	176,0	99,5	60,2	119,0	4.300
76	190,0	112,5	72,9	133,0	5.300

V. SFERA ESTRAIBILE SANIT. EL.  
SANIT. EXTRACTABLE BALL V. PE.  
V. BOULE EXTRACT. SANIT. BL.  
V. BOLA EXTRAIBILE SANIT. EL.

**W90**

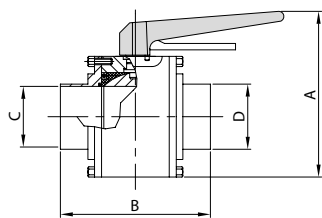

DN	A	B	C	D	gr
25	110,0	95,0	22,1	25,4	1.130
38	130,0	109,0	34,8	38,1	2.070
51	145,0	124,0	47,5	50,8	2.800
63	168,0	135,0	60,2	63,5	4.840
76	182,0	158,0	72,0	76,2	7.480

V. SFERA ESTRAIBILE SANIT. EF.  
SANIT. EXTRACTABLE BALL V. ME.  
V. BOULE EXTRACT. SANIT. BF.  
V. BOLA EXTRAIBILE SANIT. ER.

**B90**

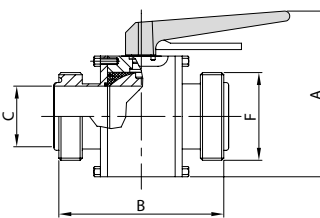

DN	A	B	C	F	gr
25	110,0	106,0	22,1	46-8	1.330
38	130,0	121,0	34,8	58-8	2.370
51	145,0	132,0	47,5	73-6	3.100
63	168,0	146,0	60,2	85-6	5.440
76	182,0	157,0	72,0	98-6	8.080

V. SFERA ESTR. SANIT. EL./EF.  
SANIT. EXTRACT. BALL V. PE./ME.  
V. BOULE EXTR. SANIT. BL./BF.  
V. BOLA EXTR. SANIT. EL./ER.

**WB90**

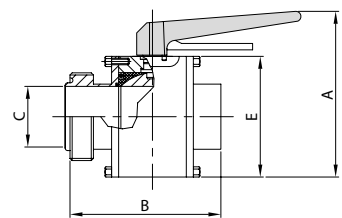

DN	A	B	C	E	gr
25	110,0	100,0	22,1	60,0	1.230
38	130,0	115,0	34,8	80,0	2.220
51	145,0	128,0	47,5	95,0	2.950
63	168,0	140,0	60,2	118,0	5.140
76	182,0	157,0	72,0	132,0	7.780



VALVOLE A SFERA  
BALL VALVES  
VANNES À BOULE  
VÁLVULAS DE BOLA



**RJT BS**

V. SFERA ESTRAIBILE EL.  
EXTRACTABLE BALL V. PE.  
V. BOULE EXTRACTION BL.  
V. BOLA EXTRAIBILE EL.

**W91**

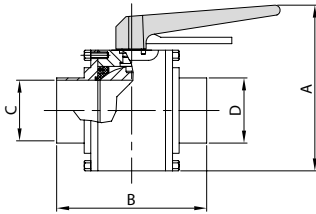

DN	A	B	C	D	gr
25	110,0	95,0	22,1	25,4	1.120
38	130,0	109,0	34,8	38,1	2.060
51	145,0	124,0	47,5	50,8	2.780
63	168,0	135,0	60,2	63,5	4.820
76	182,0	158,0	72,0	76,2	7.450

V. SFERA ESTRAIBILE EF.  
EXTRACTABLE BALL V. ME.  
V. BOULE EXTRACTION BF.  
V. BOLA EXTRAIBILE ER.

**B91**

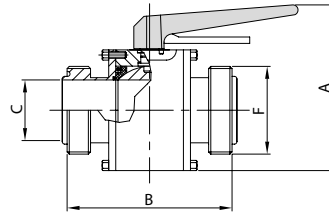

DN	A	B	C	F	gr
25	110,0	106,0	22,1	46-8	1.320
38	130,0	121,0	34,8	58-8	2.360
51	145,0	132,0	47,5	73-6	3.080
63	168,0	146,0	60,2	85-6	5.420
76	182,0	157,0	72,0	98-6	8.050

V. SFERA ESTRAIBILE EL./EF.  
EXTRACTABLE BALL V. PE./ME.  
V. BOULE EXTRACTION BL./BF.  
V. BOLA EXTRAIBILE EL./ER.

**WB91**

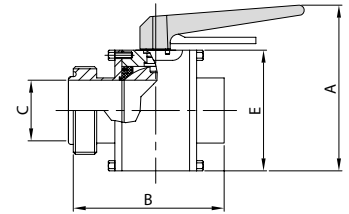

DN	A	B	C	E	gr
25	110,0	100,0	22,1	60,0	1.220
38	130,0	115,0	34,8	80,0	2.210
51	145,0	128,0	47,5	95,0	2.930
63	168,0	140,0	60,2	118,0	5.120
76	182,0	157,0	72,0	132,0	7.750



VALVOLE A SFERA  
BALL VALVES  
VANNES À BOULE  
VÁLVULAS DE BOLA



ISS IDF

VALVOLA SFERA EL.  
BALL VALVE PE.  
VANNE BOULE BL.  
VÁLVULA BOLA EL.

W81

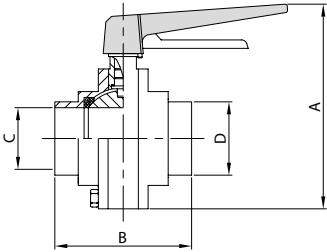

DN	A	B	C	D	gr
38	138,0	73,0	35,1	38,1	1.600
51	155,0	80,0	47,8	50,8	2.600
63	176,0	97,0	60,5	63,5	4.000
76	190,0	109,0	72,9	76,2	5.000

VALVOLA SFERA EF.  
BALL VALVE ME.  
VANNE BOULE BF.  
VÁLVULA BOLA ER.

I81

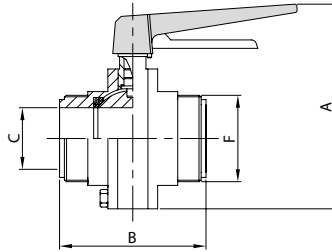

DN	A	B	C	F	gr
38	138,0	93,0	34,8	50-8	1.900
51	155,0	104,0	47,5	64-8	2.900
63	176,0	120,0	60,2	77-8	4.600
76	190,0	131,0	72,9	91-8	5.600

VALVOLA SFERA EL./EF.  
BALL VALVE PE./ME.  
VANNE BOULE BL./BF.  
VÁLVULA BOLA EL./ER.

WI81

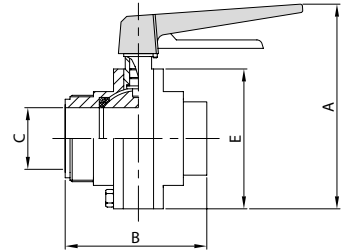

DN	A	B	C	E	gr
38	138,0	83,0	34,8	81,0	1.750
51	155,0	92,0	47,5	98,0	2.750
63	176,0	108,0	60,2	119,0	4.300
76	190,0	120,0	72,9	133,0	5.300

V. SFERA ESTRAIBILE SANIT. EL.  
SANIT. EXTRACTABLE BALL V. PE.  
V. BOULE EXTRACT. SANIT. BL.  
V. BOLA EXTRAIBILE SANIT. EL.

W90

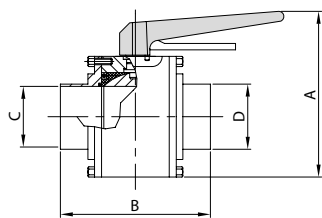

DN	A	B	C	D	gr
25	110,0	95,0	22,1	25,4	1.130
38	130,0	109,0	34,8	38,1	2.070
51	145,0	124,0	47,5	50,8	2.800
63	168,0	135,0	60,2	63,5	4.840
76	182,0	158,0	72,0	76,2	7.480

V. SFERA ESTRAIBILE SANIT. EF.  
SANIT. EXTRACTABLE BALL V. ME.  
V. BOULE EXTRACT. SANIT. BF.  
V. BOLA EXTRAIBILE SANIT. ER.

I90

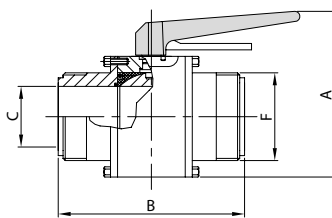

DN	A	B	C	F	gr
25	110,0	96,0	22,1	37-8	1.330
38	130,0	121,0	34,8	50-8	2.370
51	145,0	132,0	47,5	64-8	3.100
63	168,0	146,0	60,2	77-8	5.440
76	182,0	157,0	72,0	91-8	8.080

V. SFERA ESTR. SANIT. EL./EF.  
SANIT. EXTRACT. BALL V. PE./ME.  
V. BOULE EXTR. SANIT. BL./BF.  
V. BOLA EXTR. SANIT. EL./ER.

WI90

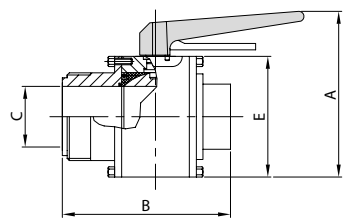

DN	A	B	C	E	gr
25	110,0	95,0	22,1	60,0	1.230
38	130,0	115,0	34,8	80,0	2.220
51	145,0	128,0	47,5	95,0	2.950
63	168,0	140,0	60,2	118,0	5.140
76	182,0	157,0	72,0	132,0	7.780





V. SFERA ESTRAIBILE EL.  
EXTRACTABLE BALL V. PE.  
V. BOULE EXTRACTION BL.  
V. BOLA EXTRAIBILE EL.

W91

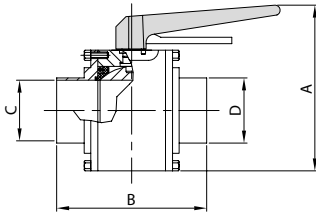

DN	A	B	C	D	gr
25	110,0	95,0	22,1	25,4	1.120
38	130,0	109,0	34,8	38,1	2.060
51	145,0	124,0	47,5	50,8	2.780
63	168,0	135,0	60,2	63,5	4.820
76	182,0	158,0	72,0	76,2	7.450

V. SFERA ESTRAIBILE EF.  
EXTRACTABLE BALL V. ME.  
V. BOULE EXTRACTION BF.  
V. BOLA EXTRAIBILE ER.

I91

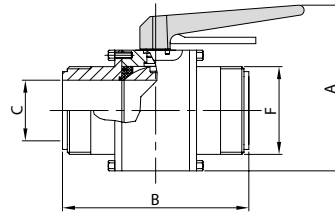

DN	A	B	C	F	gr
25	110,0	96,0	22,1	37-8	1.320
38	130,0	121,0	34,8	50-8	2.360
51	145,0	132,0	47,5	64-8	3.080
63	168,0	146,0	60,2	77-8	5.420
76	182,0	157,0	72,0	91-8	8.050

V. SFERA ESTRAIBILE EL./EF.  
EXTRACTABLE BALL V. PE./ME.  
V. BOULE EXTRACTION BL./BF.  
V. BOLA EXTRAIBILE EL./ER.

WI91

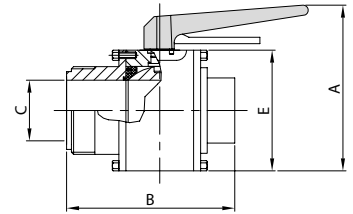

DN	A	B	C	E	gr
25	110,0	95,0	22,1	60,0	1.220
38	130,0	115,0	34,8	80,0	2.210
51	145,0	128,0	47,5	95,0	2.930
63	168,0	140,0	60,2	118,0	5.120
76	182,0	157,0	72,0	132,0	7.750



VALVOLE A SFERA  
BALL VALVES  
VANNES À BOULE  
VÁLVULAS DE BOLA



**CLAMP**

V. SFERA SAN. DRENAGGIO EL.  
SAN. DRAINAGE BALL V. PE.  
V. BOULE SAN. DRAINAGE BL.  
V. BOLA SAN. DRENAJE EL.

**W50**

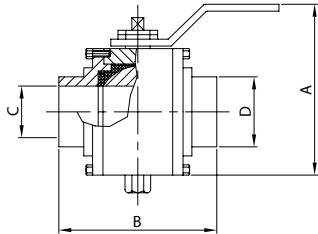

DN	A	B	C	D	gr
1" 25	90,0	95,0	22,1	25,4	1.100
1 1/2" 38	110,0	107,0	34,8	38,1	2.090
2" 51	126,0	118,0	47,5	50,8	3.140
2 1/2" 63	143,0	135,0	60,2	63,5	4.730
3" 76	163,0	158,0	72,0	76,2	6.940
4" 101	202,0	170,0	97,4	101,6	13.570

V. SFERA SAN. DR. E. SM.  
SAN. DR. BALL V. E. FR.  
V. BOULE SAN. DR. B. FR.  
V. BOLA SAN. DR. E. SM.

**K50**

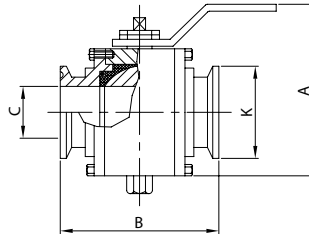

DN	A	B	C	K	gr
1" 25	90,0	95,0	22,1	50,5	1.120
1 1/2" 38	110,0	107,0	34,8	50,5	2.120
2" 51	126,0	118,0	47,5	64,0	3.190
2 1/2" 63	143,0	135,0	60,2	77,5	4.790
3" 76	163,0	158,0	72,0	91,0	7.010
4" 101	202,0	170,0	97,4	119,0	13.670

V. SFERA SAN. DR. EL./E. SM.  
SAN. DR. BALL V. PE./E. FR.  
V. BOULE SAN. DR. BL./B. FR.  
V. BOLA SAN. DR. EL./E. SM.

**WK50**

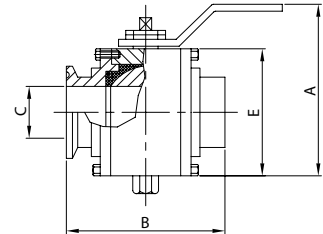

DN	A	B	C	E	gr
1" 25	90,0	95,0	22,1	58,0	1.110
1 1/2" 38	110,0	107,0	34,8	77,0	2.105
2" 51	126,0	118,0	47,5	93,0	3.165
2 1/2" 63	143,0	135,0	60,2	113,0	4.760
3" 76	163,0	158,0	72,0	129,0	6.975
4" 101	202,0	170,0	97,4	169,0	13.620

VALVOLA SFERA DRENAGGIO EL.  
DRAINAGE BALL VALVE PE.  
VANNES BOULE DRAINAGE BL.  
VÁLVULA BOLA DRENAJE EL.

**W51**

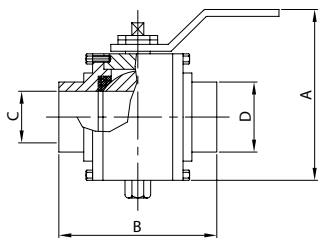

DN	A	B	C	D	gr
1" 25	90,0	95,0	22,1	25,4	1.090
1 1/2" 38	110,0	107,0	34,8	38,1	2.080
2" 51	126,0	118,0	47,5	50,8	3.120
2 1/2" 63	143,0	135,0	60,0	63,5	4.710
3" 76	163,0	158,0	72,0	76,2	6.910
4" 101	202,0	170,0	97,0	101,6	13.530

V. SFERA DRENAGGIO E. SM.  
DRAINAGE BALL V. E. FR.  
V. BOULE DRAINAGE B. FR.  
V. BOLA DRENAJE E. SM.

**K51**

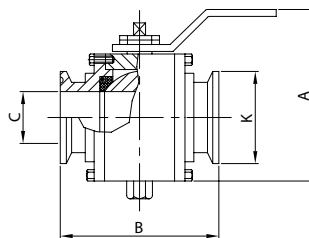

DN	A	B	C	K	gr
1" 25	90,0	95,0	22,1	50,5	1.110
1 1/2" 38	110,0	107,0	34,8	50,5	2.110
2" 51	126,0	118,0	47,5	64,0	3.170
2 1/2" 63	143,0	135,0	60,0	77,5	4.770
3" 76	163,0	158,0	72,0	91,0	6.980
4" 101	202,0	170,0	97,0	119,0	13.630

V. SFERA DRENAGGIO EL./E. SM.  
DRAINAGE BALL V. PE./E. FR.  
V. BOULE DRAINAGE BL./B. FR.  
V. BOLA DRENAJE EL./E. SM.

**WK51**

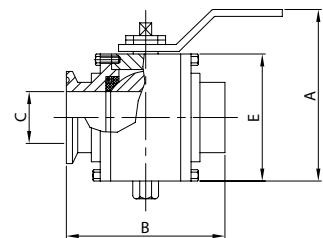

DN	A	B	C	E	gr
1" 25	90,0	95,0	22,1	58,0	1.110
1 1/2" 38	110,0	107,0	34,8	77,0	2.095
2" 51	126,0	118,0	47,5	93,0	3.145
2 1/2" 63	143,0	135,0	60,0	113,0	4.740
3" 76	163,0	158,0	72,0	129,0	6.945
4" 101	202,0	170,0	97,0	169,0	13.580